

Thrustmaster Y-350P 7.1 POWERED gaming headset



FAQ 1: Is my Y-350P headset compatible with the PS4™ Pro?

The Y-350P headset is compatible with the PS4™, PS4™ Slim and PS4™ Pro systems.

FAQ 2: Is my Y-350P headset compatible with my controller?

The Y-350P headset is compatible with the DualShock®4 controller.

If you are using another controller, you can connect your headset directly to it if your controller features a 3.5 mm audio output jack. However, in that case you will not be able to take advantage of the control function and the 7.1 function of your Y Sound Commander.

FAQ 3: How do I power off the Y Sound Commander?

In order to power off the Y Sound Commander and preserve its battery power, disconnect the Y Sound Commander from your game controller and set the switch to the OFF position.

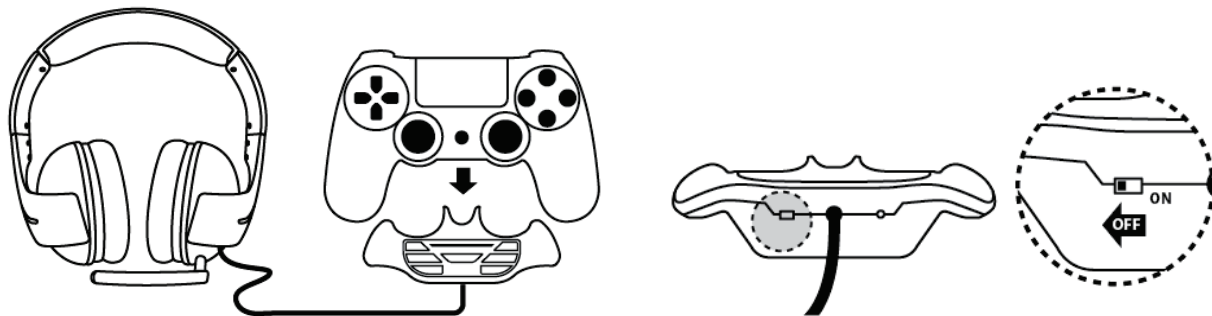

FAQ 4: The microphone isn't working. What should I do?

1. Make sure that your microphone is properly connected to the headset.

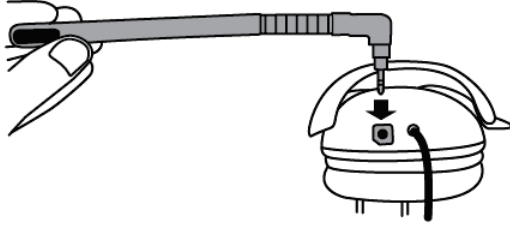

2. Make sure that the headset is properly connected to the Y Sound Commander.

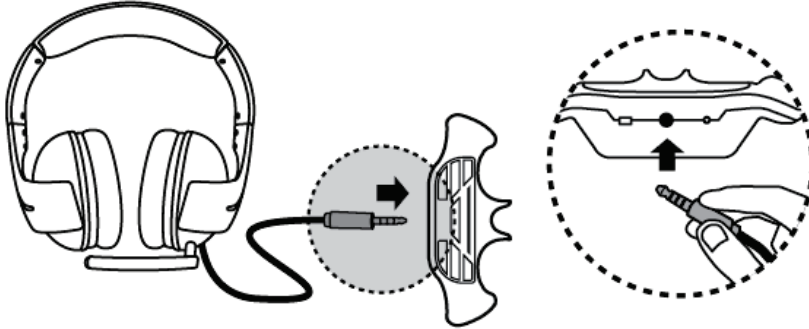

3. Make sure that the switch on the Y Sound Commander is set to the ON position.

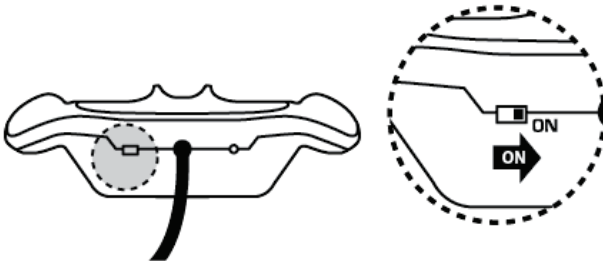

4. Make sure that the microphone is enabled (LED lit up in blue) on the Y Sound Commander.



If the microphone still isn't working: disconnect the Y Sound Commander from the DualShock®4 controller, and then connect it again.

FAQ 5: The audio isn't working. What should I do?

1. Make sure that the headset is properly connected to the Y Sound Commander.

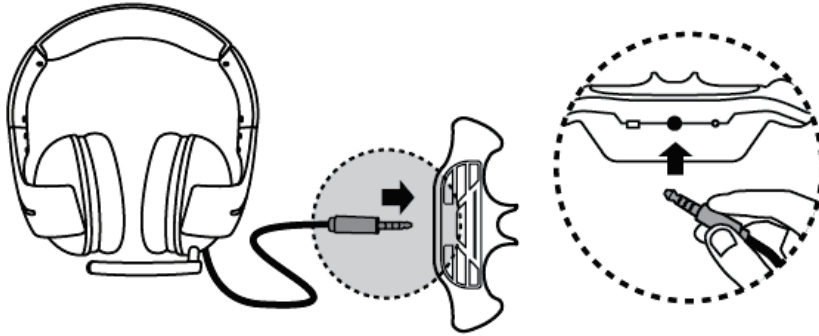

2. Make sure that the Y Sound Commander is properly connected to the DualShock®4 controller.

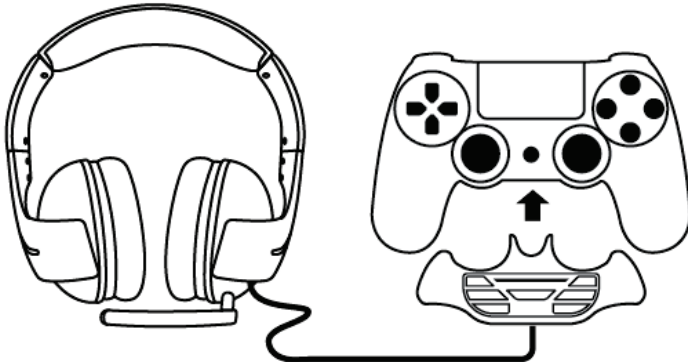

3. Make sure that the switch on the Y Sound Commander is set to the ON position.

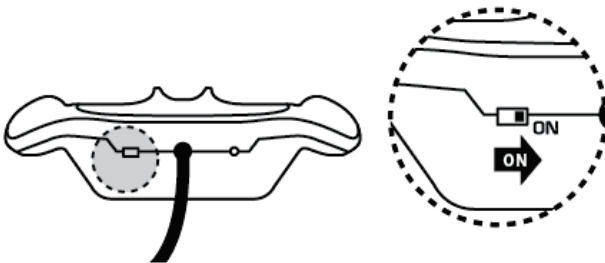

4. Make sure that the DualShock®4 controller is powered on, and paired with the console.
5. If the audio still isn't working: disconnect the Y Sound Commander from the DualShock®4 controller, and power off your controller. Connect the Y Sound Commander to the controller again, and then power your controller back on.

FAQ 6: My Y Sound Commander is powered off, but the charge indicator LED is lit up in red. Is that normal?

This is normal. The charge indicator LED lights up in red to indicate that the battery level of your Y Sound Commander is low, whether the Y Sound Commander is powered on or powered off.

You should recharge your Y Sound Commander in order to take full advantage of all your headset's functions.

FAQ 7: My Y Sound Commander is powered off, but there's no sound on my TV set. Is that normal?

This is normal. When your Y Sound Commander is powered off (with the switch set to the OFF position, or when there's no battery power remaining), it is still detected by your PS4™ console.

Disconnect the Y Sound Commander from the game controller in order to be able to hear the sound of your game on your TV set.

FAQ 8: My headset is disconnected, but there's no sound on my TV set. Is that normal?

This is normal. When your headset is disconnected, but the Y Sound Commander remains connected to the game controller, the Y Sound Commander is still detected by your PS4™ console.

Disconnect the Y Sound Commander from the game controller in order to be able to hear the sound of your game on your TV set.